

# — 11530 CHAIRMAN DRIVE —

FROM 1,425 SQUARE FEET TO 17,190 SQUARE FEET OF  
OFFICE/TECHNOLOGY SPACE AVAILABLE FOR LEASE



## 11530 CHAIRMAN DRIVE, DALLAS, TEXAS 75243

- FROM 1,425 SQ FT TO 17,190 SQUARE FEET
- FRONT AND REAR GRADE LEVEL LOADING
- WHITE INSULATED ROOF INSTALLED IN 2013
- LARGE TRUCK COURTS
- APPROXIMATELY 14' CLEAR HEIGHT
- ENTRANCES WITH METAL AWNINGS
- FLOOR TO CEILING TINTED GLASS
- CONCRETE PARKING
- SKYLIGHTS
- PROFESSIONAL PROPERTY MANAGEMENT
- GREAT ACCESS TO 635

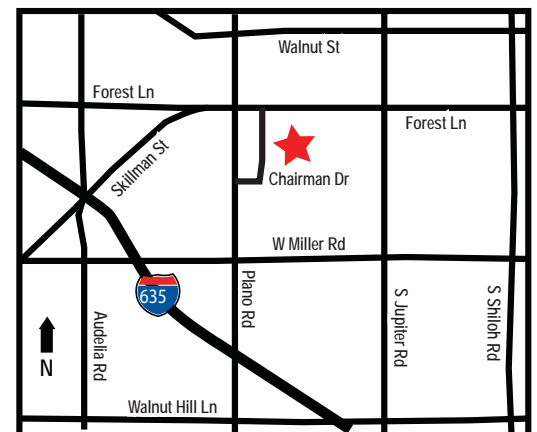

FOR INFORMATION CONTACT:

**MARK ASTON**  
(972) 889-4400

**MIKE FAY**  
(972) 889-4410

**TRAVIS BOURGEOIS**  
(972) 889-4404

THE INFORMATION CONTAINED HEREIN WAS OBTAINED FROM SOURCES BELIEVED RELIABLE; HOWEVER, MAVERICK COMMERCIAL MAKES NO GUARANTEES, WARRANTIES OR REPRESENTATION AS TO THE COMPLETENESS OR ACCURACY THEREOF. THE PRESENTATION OF THIS PROPERTY IS SUBMITTED SUBJECT TO ERRORS, OMISSIONS, CHANGE OF PRICE OR CONDITIONS PRIOR TO SALE OR LEASE OR WITHDRAW WITHOUT NOTICE.

FULL-SERVICE COMMERCIAL REAL ESTATE SERVICES INCLUDING MARKETING, MANAGEMENT, DEVELOPMENT, INVESTMENT, AND CORPORATE SERVICES  
1571 NORTH GLENVILLE DRIVE, SUITE 150, RICHARDSON, TEXAS, 75081 • 972-889-9000 • FAX 972-889-1500 • WWW.MAVERICKCOMMERCIAL.COM



# 11530 CHAIRMAN DRIVE

FROM 1,425 SQUARE FEET TO 17,190 SQUARE FEET OF OFFICE/TECHNOLOGY SPACE AVAILABLE FOR LEASE

## 11530 CHAIRMAN DRIVE

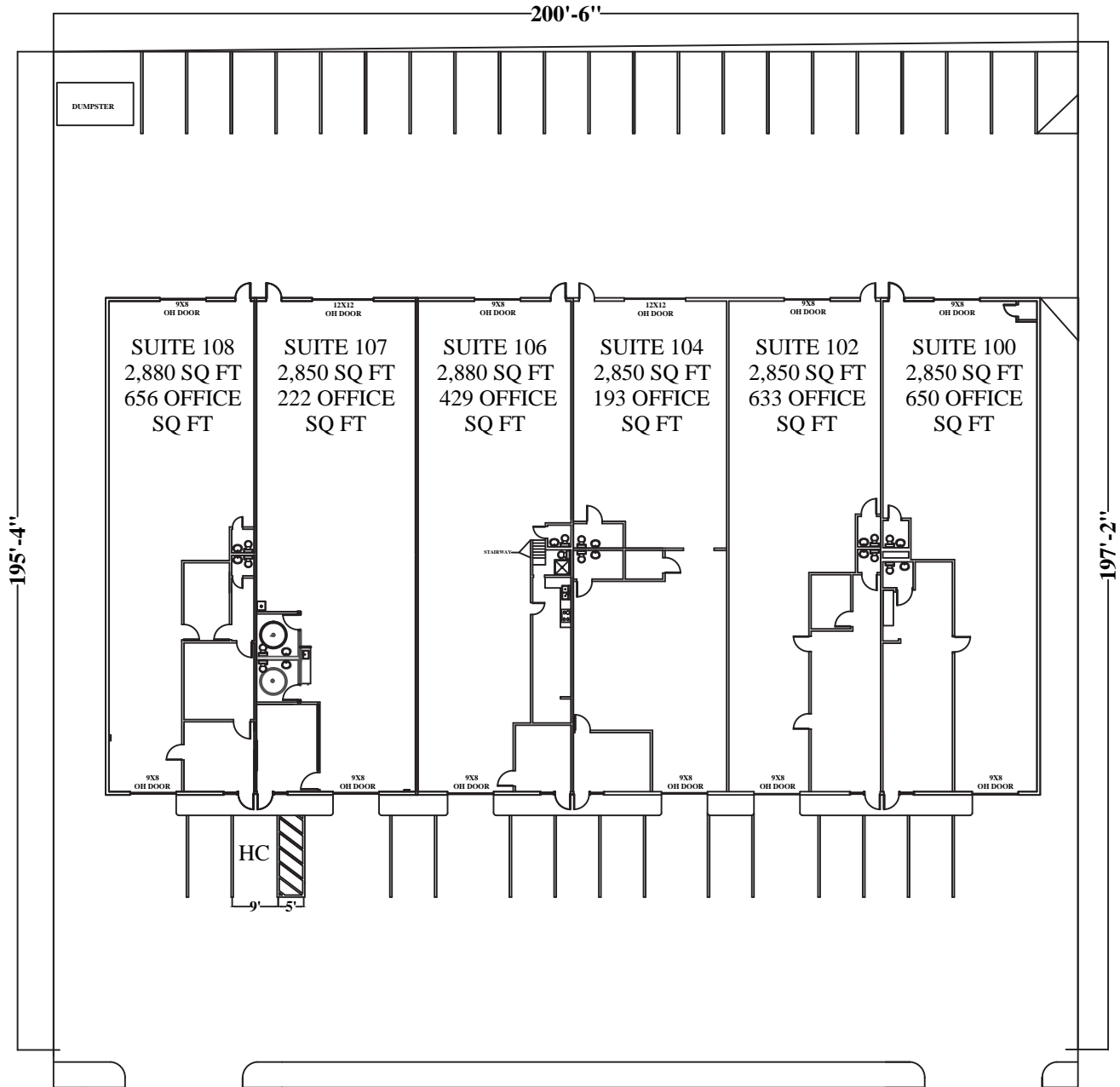

11530 CHAIRMAN DRIVE  
SUITES 100, 102, 104, 106, 107, 108  
DALLAS, TX



THE INFORMATION CONTAINED HEREIN WAS OBTAINED FROM SOURCES BELIEVED RELIABLE; HOWEVER, MAVERICK COMMERCIAL MAKES NO GUARANTEES, WARRANTIES OR REPRESENTATION AS TO THE COMPLETENESS OR ACCURACY THEREOF. THE PRESENTATION OF THIS PROPERTY IS SUBMITTED SUBJECT TO ERRORS, OMISSIONS, CHANGE OF PRICE OR CONDITIONS PRIOR TO SALE OR LEASE OR WITHDRAW WITHOUT NOTICE.