

— AVENUE N —

OFFERING FROM 960 SQ FT TO 35,958 SQ FT
OFFICE/SERVICE/SHOWROOM



1209 AVENUE N, PLANO, TEXAS 75074

- FROM 960 SQ FT TO 35,958 SQ FT
- MINUTES FROM US-75 AND GEORGE BUSH 190
- APPROX. 14' CLEAR HEIGHT
- RECESSED ENTRANCES
- FLOOR TO CEILING TINTED GLASS
- CUSTOM DESIGNED INTERIORS
- PROMINENT TENANT IDENTIFICATION
- CONCRETE PARKING AND REAR LOADING
- CAMPUS-LIKE SETTING
- YEAR-ROUND LANDSCAPING
- MULTIPLE FIBER PROVIDED TO SITE
- SPRINKLERED
- PROFESSIONAL PROPERTY MANAGEMENT

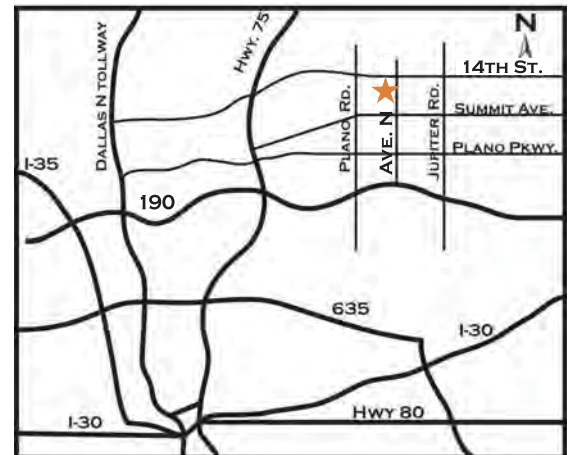

MAVERICK
COMMERCIAL REAL ESTATE

FOR INFORMATION CONTACT:

MARK ASTON
(972) 889-4400

MIKE FAY
(972) 889-4410

TRAVIS BOURGEOIS
(972) 889-4404



THE INFORMATION CONTAINED HEREIN WAS OBTAINED FROM SOURCES BELIEVED RELIABLE; HOWEVER, MAVERICK COMMERCIAL MAKES NO GUARANTEES, WARRANTIES OR REPRESENTATION AS TO THE COMPLETENESS OR ACCURACY THEREOF. THE PRESENTATION OF THIS PROPERTY IS SUBMITTED SUBJECT TO ERRORS, OMISSIONS, CHANGE OF PRICE OR CONDITIONS PRIOR TO SALE OR LEASE OR WITHDRAW WITHOUT NOTICE.

FULL-SERVICE COMMERCIAL REAL ESTATE SERVICES INCLUDING MARKETING, MANAGEMENT, DEVELOPMENT, INVESTMENT, AND CORPORATE SERVICES
1571 NORTH GLENVILLE DRIVE, SUITE 150, RICHARDSON, TEXAS, 75081 972-889-9000 FAX 972-889-1500 WWW.MAVERICKCOMMERCIAL.COM

— AVENUE N —

OFFERING FROM 960 SQ FT TO 35,958 SQ FT
OFFICE/SERVICE/SHOWROOM

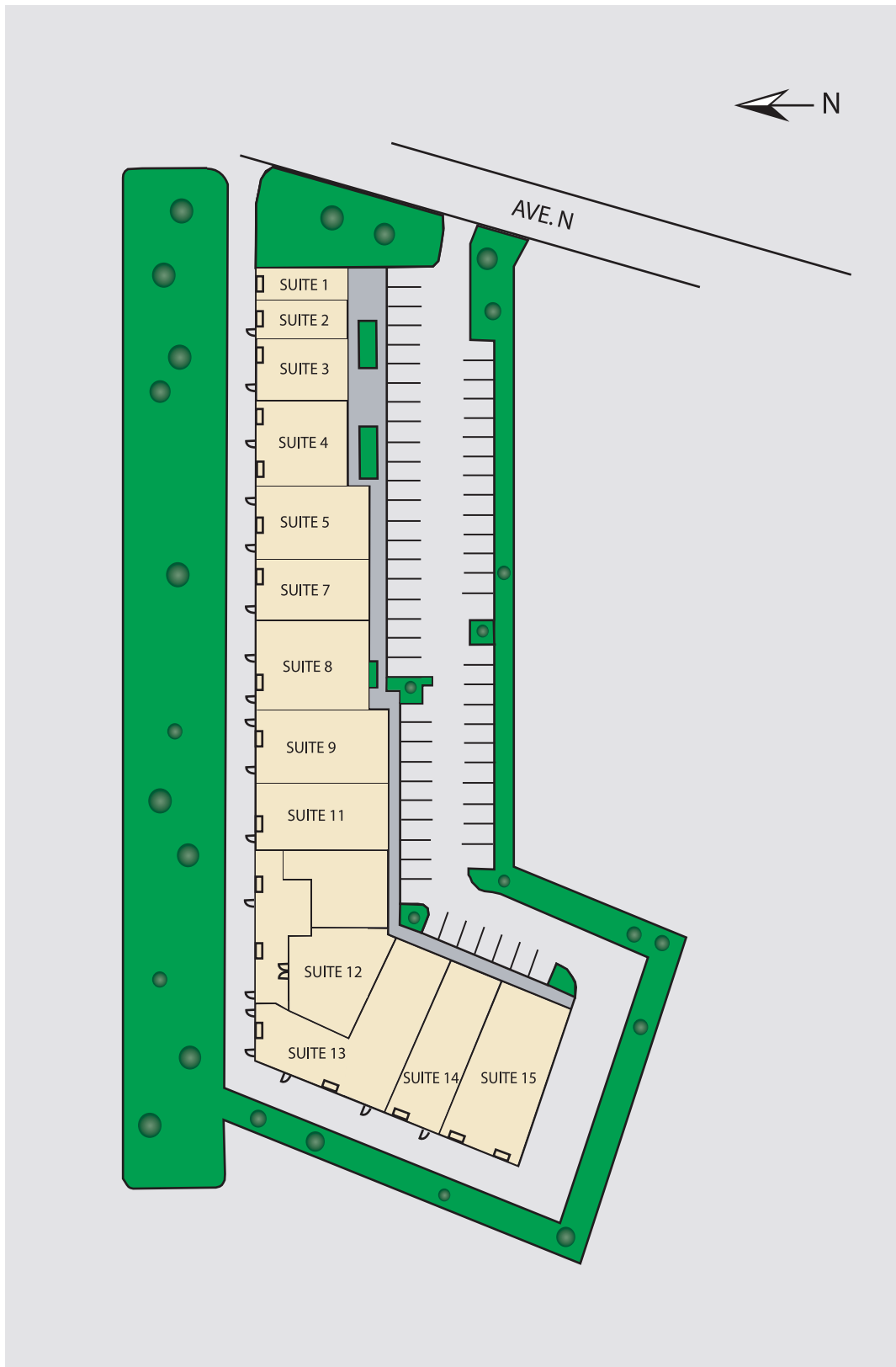

THE INFORMATION CONTAINED HEREIN WAS OBTAINED FROM SOURCES BELIEVED RELIABLE; HOWEVER, MAVERICK COMMERCIAL MAKES NO GUARANTEES, WARRANTIES OR REPRESENTATION AS TO THE COMPLETENESS OR ACCURACY THEREOF. THE PRESENTATION OF THIS PROPERTY IS SUBMITTED SUBJECT TO ERRORS, OMISSIONS, CHANGE OF PRICE OR CONDITIONS PRIOR TO SALE OR LEASE OR WITHDRAW WITHOUT NOTICE.