

SALE/LEASE — 5108 COCKRELL HILL ROAD —

FROM 36,180 UP TO 96,120 SQUARE FEET AVAILABLE FOR LEASE



5108-5122 COCKRELL HILL ROAD, DALLAS, TEXAS 75236

- FROM 36,180 SQUARE FEET UP TO 96,120 SQUARE FEET FOR LEASE
- FREESTANDING BUILDING FRONTING ON COCKRELL HILL ROAD
- SITUATED ON APPROXIMATELY 5 ACRES OF LAND
- FENCED-IN CONCRETE PARKING, TRUCK COURT AND STORAGE SURROUNDING THE BUILDING
- CLEAR HEIGHT APPROXIMATELY 20'-22'
- SPRINKLERED
- DOCK HIGH LOADING FACILITIES
- MANUFACTURING/DISTRIBUTION FACILITY
- POWER IS 2000 AMPS AT 480V AND 1200 AMPS AT 240V
- ACTIVE RAIL BEHIND THE PROPERTY, BUT NO SPUR
- EXCELLENT ACCESS TO LOOP 12, I-20, HWY 67, AND I-35
- CLOSE PROXIMITY TO DFW INTERNATIONAL AIRPORT
- CLOSE PROXIMITY TO REDBIRD AIRPORT
- PROMINENT TENANT IDENTIFICATION
- RECESSED ENTRANCES

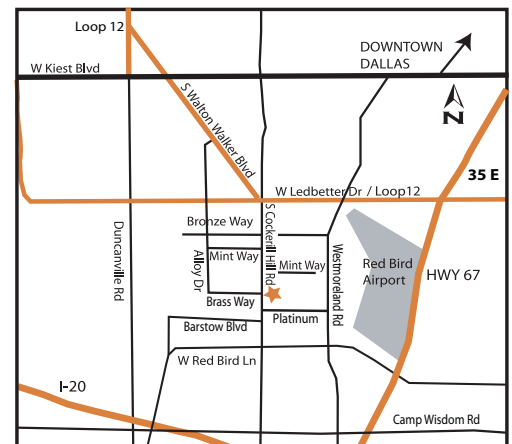

MAVERICK
COMMERCIAL REAL ESTATE

TRAVIS BOURGEOIS
(972) 889-4404

FOR INFORMATION CONTACT:

MARK ASTON
(972) 889-4400

MIKE FAY
(972) 889-4410



THE INFORMATION CONTAINED HEREIN WAS OBTAINED FROM SOURCES BELIEVED RELIABLE; HOWEVER, MAVERICK COMMERCIAL MAKES NO GUARANTEES, WARRANTIES OR REPRESENTATION AS TO THE COMPLETENESS OR ACCURACY THEREOF. THE PRESENTATION OF THIS PROPERTY IS SUBMITTED SUBJECT TO ERRORS, OMISSIONS, CHANGE OF PRICE OR CONDITIONS PRIOR TO SALE OR LEASE OR WITHDRAW WITHOUT NOTICE.

FULL-SERVICE COMMERCIAL REAL ESTATE SERVICES INCLUDING MARKETING, MANAGEMENT, DEVELOPMENT, INVESTMENT, AND CORPORATE SERVICES
1571 NORTH GLENVILLE DRIVE, SUITE 150, RICHARDSON, TEXAS, 75081 • 972-889-9000 • FAX 972-889-1500 • WWW.MAVERICKCOMMERCIAL.COM

SALE/LEASE

— 5108-5122 COCKRELL HILL ROAD —

FROM 36,180 UP TO 96,120 SQUARE FEET AVAILABLE FOR LEASE

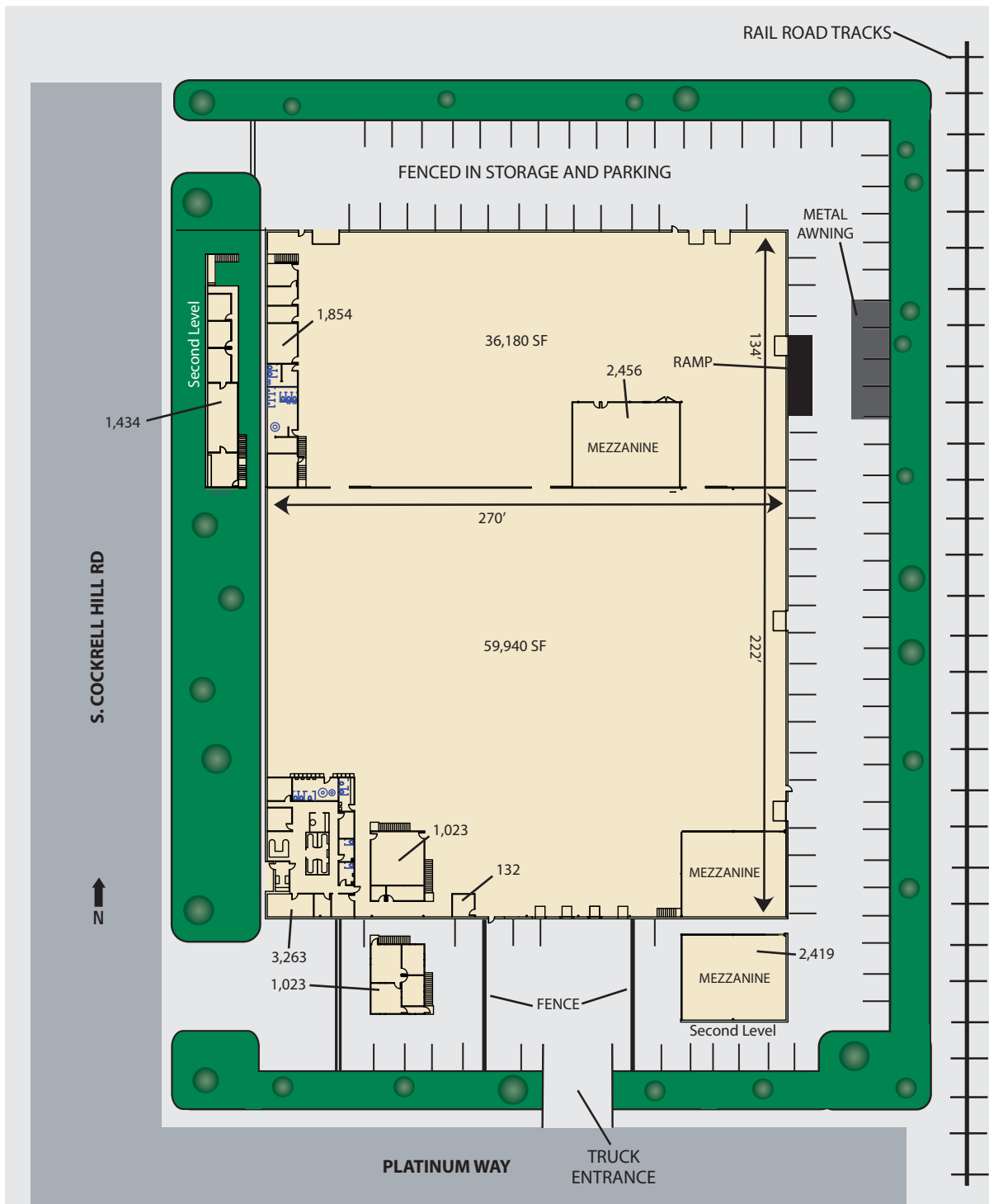

THE INFORMATION CONTAINED HEREIN WAS OBTAINED FROM SOURCES BELIEVED RELIABLE; HOWEVER, MAVERICK COMMERCIAL MAKES NO GUARANTEES, WARRANTIES OR REPRESENTATION AS TO THE COMPLETENESS OR ACCURACY THEREOF. THE PRESENTATION OF THIS PROPERTY IS SUBMITTED SUBJECT TO ERRORS, OMISSIONS, CHANGE OF PRICE OR CONDITIONS PRIOR TO SALE OR LEASE OR WITHDRAW WITHOUT NOTICE.