

— 11530 CHAIRMAN DRIVE —

FROM 1,425 SQUARE FEET TO 17,160 SQUARE FEET OF
OFFICE/TECHNOLOGY SPACE AVAILABLE FOR LEASE



11530 CHAIRMAN DRIVE, DALLAS, TEXAS 75243

- FROM 1,425 SQ FT TO 17,160 SQUARE FEET
- MULTIPLE FIBER PROVIDED TO SITE
- FRONT AND REAR GRADE LEVEL LOADING
- WHITE INSULATED ROOF INSTALLED IN 2013
- LARGE TRUCK COURTS
- APPROXIMATELY 14' CLEAR HEIGHT
- ENTRANCES WITH METAL AWNINGS
- FLOOR TO CEILING TINTED GLASS
- CONCRETE PARKING
- SKYLIGHTS
- PROFESSIONAL PROPERTY MANAGEMENT
- GREAT ACCESS TO 635

FOR INFORMATION CONTACT:

MARK ASTON
(972) 889-4400

MIKE FAY
(972) 889-4410

TRAVIS BOURGEOIS
(972) 889-4404

MAVERICK
COMMERCIAL REAL ESTATE

THE INFORMATION CONTAINED HEREIN WAS OBTAINED FROM SOURCES BELIEVED RELIABLE; HOWEVER, MAVERICK COMMERCIAL MAKES NO GUARANTEES, WARRANTIES OR REPRESENTATION AS TO THE COMPLETENESS OR ACCURACY THEREOF. THE PRESENTATION OF THIS PROPERTY IS SUBMITTED SUBJECT TO ERRORS, OMISSIONS, CHANGE OF PRICE OR CONDITIONS PRIOR TO SALE OR LEASE OR WITHDRAW WITHOUT NOTICE.

FULL-SERVICE COMMERCIAL REAL ESTATE SERVICES INCLUDING MARKETING, MANAGEMENT, DEVELOPMENT, INVESTMENT, AND CORPORATE SERVICES
1571 NORTH GLENVILLE DRIVE, SUITE 150, RICHARDSON, TEXAS, 75081 • 972-889-9000 • FAX 972-889-1500 • WWW.MAVERICKCOMMERCIAL.COM



— 11530 CHAIRMAN DRIVE —

FROM 1,425 SQUARE FEET TO 17,160 SQUARE FEET OF
OFFICE/TECHNOLOGY SPACE AVAILABLE FOR LEASE

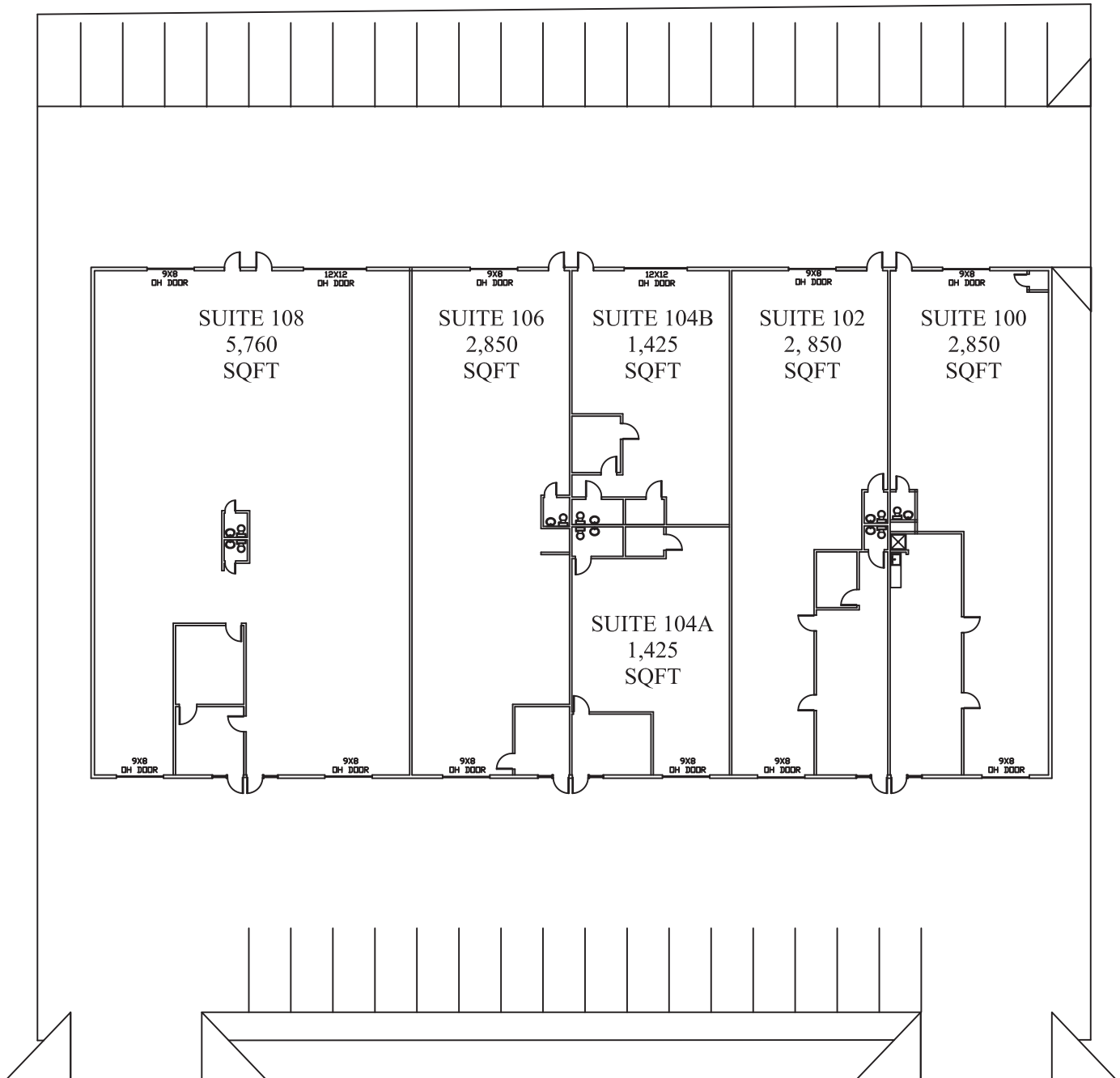

11530 CHAIRMAN DRIVE
SUITES 100, 102, 104A, 104B, 106, 108
DALLAS, TX



THE INFORMATION CONTAINED HEREIN WAS OBTAINED FROM SOURCES BELIEVED RELIABLE; HOWEVER, MAVERICK COMMERCIAL MAKES NO GUARANTEES, WARRANTIES OR REPRESENTATION AS TO THE COMPLETENESS OR ACCURACY THEREOF. THE PRESENTATION OF THIS PROPERTY IS SUBMITTED SUBJECT TO ERRORS, OMISSIONS, CHANGE OF PRICE OR CONDITIONS PRIOR TO SALE OR LEASE OR WITHDRAW WITHOUT NOTICE.

