

— SPRING CREEK — BUSINESS PARK

FROM APPROXIMATELY 3,578 SQUARE FEET TO 80,038 SQUARE FEET OF
OFFICE/SHOWROOM/WAREHOUSE SPACE FOR LEASE



1800-1820 NORTH GLENVILLE DRIVE, RICHARDSON, TEXAS 75081

- FROM APPROXIMATELY 3,578 SQ FT TO 80,038 SQ FT
- LOCATED IN THE TELECOM CORRIDOR®
- APPROXIMATELY 14'-18' CLEAR HEIGHT
- RECESSED ENTRANCES
- PROMINENT TENANT IDENTIFICATION
- CONCRETE PARKING AND REAR LOADING
- DOCK HIGH AND GRADE LEVEL LOADING
- EXCELLENT ACCESS TO CENTRAL EXPRESSWAY (75), GEORGE BUSH (190) AND LBJ FREEWAY (635)
- CLOSE PROXIMITY TO A WIDE VARIETY OF HOTELS, RESTAURANTS AND SHOPPING
- NEW \$90,000,000 MIXED-USE PROJECT KNOWN AS EASTSIDE IS A COUPLE OF BLOCKS AWAY
- DART RAIL SERVICE AVAILABLE AT THE ARAPAHO AND THE GALATYN STATION
- PROPERTY NEAR DART BUS LINE
- PROFESSIONAL PROPERTY MANAGEMENT



MAVERICK
COMMERCIAL REAL ESTATE

FOR INFORMATION CONTACT:

MARK ASTON
(972) 889-4400

MIKE FAY
(972) 889-4410

TRAVIS BOURGEOIS
(972) 889-4404

THE INFORMATION CONTAINED HEREIN WAS OBTAINED FROM SOURCES BELIEVED RELIABLE; HOWEVER, MAVERICK COMMERCIAL MAKES NO GUARANTEES, WARRANTIES OR REPRESENTATION AS TO THE COMPLETENESS OR ACCURACY THEREOF. THE PRESENTATION OF THIS PROPERTY IS SUBMITTED SUBJECT TO ERRORS, OMISSIONS, CHANGE OF PRICE OR CONDITIONS PRIOR TO SALE OR LEASE OR WITHDRAW WITHOUT NOTICE.

FULL-SERVICE COMMERCIAL REAL ESTATE SERVICES INCLUDING MARKETING, MANAGEMENT, DEVELOPMENT, INVESTMENT, AND CORPORATE SERVICES
1571 NORTH GLENVILLE DRIVE, SUITE 150, RICHARDSON, TEXAS, 75081 • 972-889-9000 • FAX 972-889-1500 • WWW.MAVERICKCOMMERCIAL.COM



SPRING CREEK BUSINESS PARK

FROM APPROXIMATELY 3,578 SQUARE FEET TO 80,038 SQUARE FEET OF OFFICE/SHOWROOM/WAREHOUSE SPACE FOR LEASE

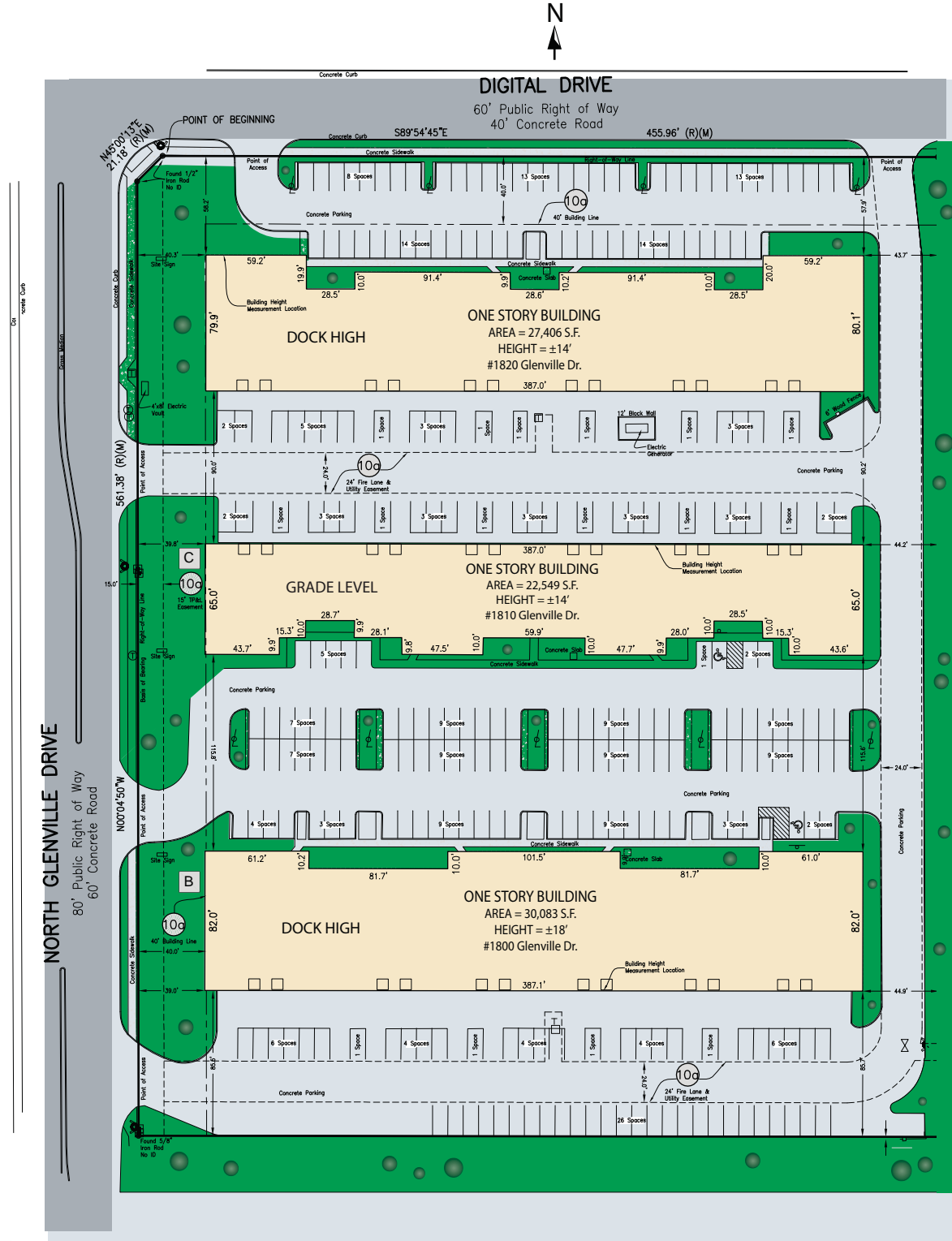

THE INFORMATION CONTAINED HEREIN WAS OBTAINED FROM SOURCES BELIEVED RELIABLE; HOWEVER, MAVERICK COMMERCIAL MAKES NO GUARANTEES, WARRANTIES OR REPRESENTATION AS TO THE COMPLETENESS OR ACCURACY THEREOF. THE PRESENTATION OF THIS PROPERTY IS SUBMITTED SUBJECT TO ERRORS, OMISSIONS, CHANGE OF PRICE OR CONDITIONS PRIOR TO SALE OR LEASE OR WITHDRAW WITHOUT NOTICE.