

# PALISADES III

FROM APPROXIMATELY 12,788 SQ FT UP TO 59,046 SQ FT FOR LEASE



1601 SUMMIT AVENUE, PLANO, TEXAS 75074

- FROM APPROXIMATELY 8,251 SQ FT UP TO 59,046 SQ FT AVAILABLE FOR LEASE
- APPROXIMATELY 20' CLEAR HEIGHT
- SPRINKLERED
- HEAVY POWER
- DOCK HIGH LOADING AND LARGE TRUCK COURTS
- CONCRETE PARKING AND REAR LOADING
- CAMPUS-LIKE SETTING
- YEAR ROUND LANDSCAPING
- EXCELLENT ACCESS TO BUSH (190), CENTRAL EXPRESSWAY (75), AND LBJ FREEWAY (635)
- DART RAIL SERVICE AVAILABLE AT 15TH STREET
- PROPERTY NEAR DART BUS LINE
- CLOSE PROXIMITY TO A WIDE VARIETY OF HOTELS, RESTAURANTS AND SHOPPING
- FLOOR TO CEILING TINTED GLASS
- RECESSED ENTRANCE
- PROMINENT TENANT IDENTIFICATION
- PROFESSIONAL PROPERTY MANAGEMENT

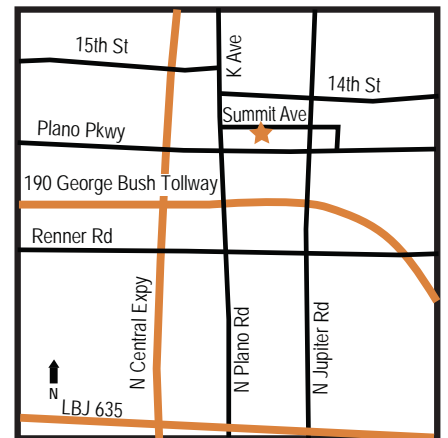

FOR INFORMATION CONTACT:

**MARK ASTON**  
(972) 889-4400

**MIKE FAY**  
(972) 889-4410

**MAVERICK**  
COMMERCIAL REAL ESTATE

**BRAD LIPTON**  
(972) 889-4404

THE INFORMATION CONTAINED HEREIN WAS OBTAINED FROM SOURCES BELIEVED RELIABLE; HOWEVER, MAVERICK COMMERCIAL MAKES NO GUARANTEES, WARRANTIES OR REPRESENTATION AS TO THE COMPLETENESS OR ACCURACY THEREOF. THE PRESENTATION OF THIS PROPERTY IS SUBMITTED SUBJECT TO ERRORS, OMISSIONS, CHANGE OF PRICE OR CONDITIONS PRIOR TO SALE OR LEASE OR WITHDRAW WITHOUT NOTICE.

FULL-SERVICE COMMERCIAL REAL ESTATE SERVICES INCLUDING MARKETING, MANAGEMENT, DEVELOPMENT, INVESTMENT, AND CORPORATE SERVICES  
1571 NORTH GLENVILLE DRIVE, SUITE 150, RICHARDSON, TEXAS, 75081 • 972-889-9000 • FAX 972-889-1500 • WWW.MAVERICKCOMMERCIAL.COM



# PALISADES III

FROM APPROXIMATELY 12,788 SQ FT UP TO 59,046 SQ FT FOR LEASE

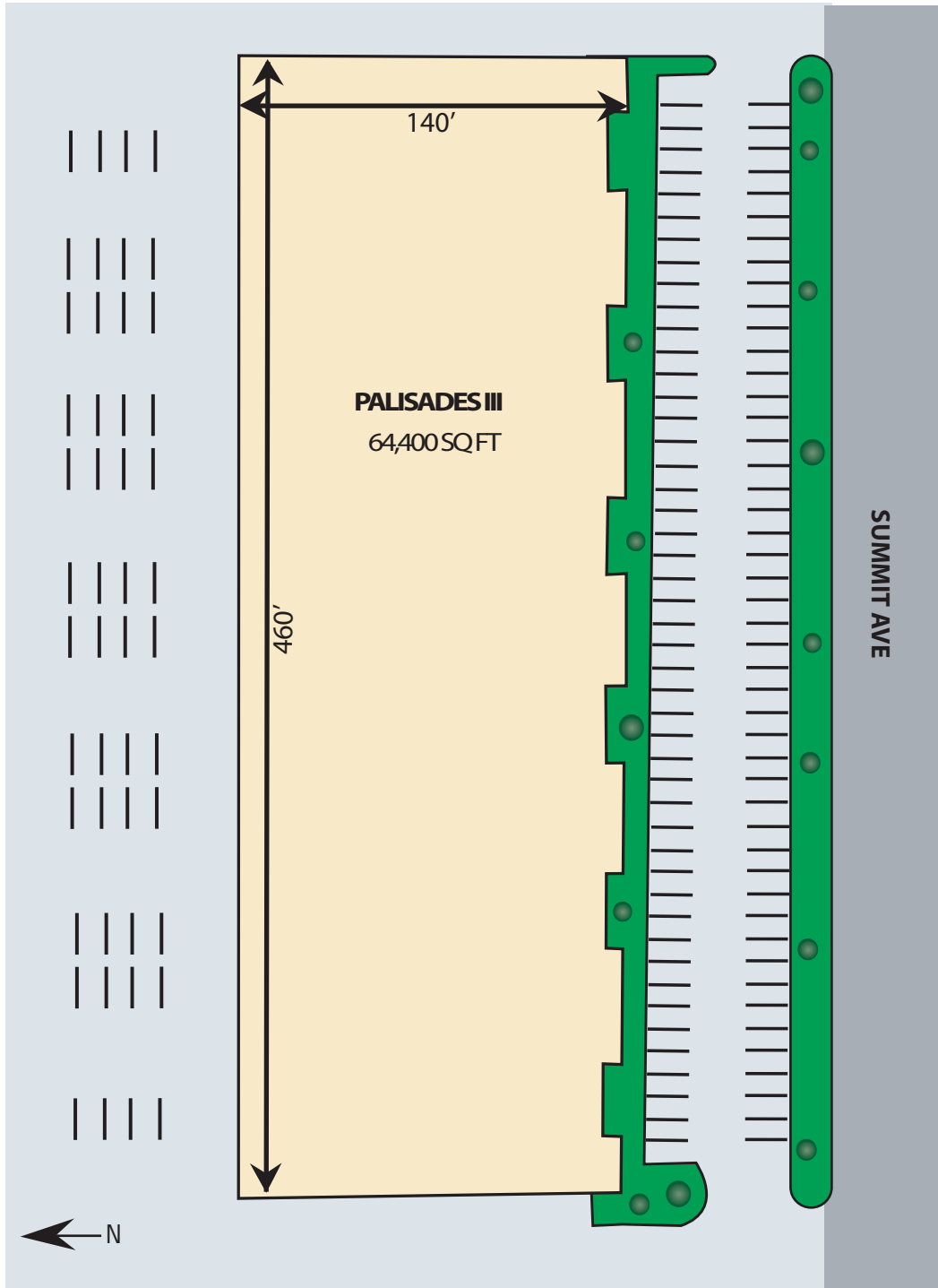

THE INFORMATION CONTAINED HEREIN WAS OBTAINED FROM SOURCES BELIEVED RELIABLE; HOWEVER, MAVERICK COMMERCIAL MAKES NO GUARANTEES, WARRANTIES OR REPRESENTATION AS TO THE COMPLETENESS OR ACCURACY THEREOF. THE PRESENTATION OF THIS PROPERTY IS SUBMITTED SUBJECT TO ERRORS, OMISSIONS, CHANGE OF PRICE OR CONDITIONS PRIOR TO SALE OR LEASE OR WITHDRAW WITHOUT NOTICE.